

ASO Safety Solutions

25mm x 45mm SENTIR Edges and End Caps

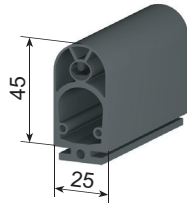

1502-2113



SENTIR safety contact edges are pressure-sensitive sensors used to ensure the safety of closing edges at possible crushing or shearing points which are prone to accidents. They may be installed near automatic gates, machines and other facilities for handling equipment to detect conditions that could cause bodily harm or damage machinery.



1502-2115

M8 Connector

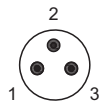

Use pins 1 and 3 for continuity.

Features

- Optimized material properties guarantee fast switching results.
- 4 edge lengths available that can be easily cut to fit any application
- Can wire in 2 or 4-wire circuits
- Requires aluminum mounting rail (included with 2ft and 5ft edges) and offered in varying lengths
- Reference example connection drawings for easy product selection



1804-1385



1804-1375



1804-0575



2002-0230



9501-0160

ASO Safety Contact Edges - 45mm

Part Number	Price	Profile	Length	End Caps	Aluminum Mounting Rail
1502-2113		25 x 45 mm [0.787 x 1.77 in]	2ft [0.610 m]	End caps not included; choose from table below	Included
1502-2114		25 x 45 mm [0.787 x 1.77 in]	5ft [1.52 m]		Included
1502-2115		25 x 45 mm [0.787 x 1.77 in]	20ft [6.10 m]		Not included
1502-2610		25 x 45 mm [0.787 x 1.77 in]	82ft [25.00 m]		Not included

ASO Safety Contact Edge End Caps - 45mm

Part Number	Price	Description	Connection
1804-1385		End cap for 25 x 45 mm safety contact edges	3-pin female M8 connector; 1.65 ft [0.5 m] cable length
1804-1375		End cap for 25 x 45 mm safety contact edges	3-pin male M8 connector; 1.65 ft [0.5 m] cable length
1804-0575		Terminating resistor end cap for 25 x 45 mm safety contact edges, 8.2 k ohm	NA

ASO Safety Contact Edge Mounting Rails

Part Number	Price	Description	Material	Contents
2002-0230		Contact edge mounting rail	Aluminum	Package of 4 rails, each 5ft [1.52 m] length
2002-0231		Contact edge mounting rail	Aluminum	1 rail, 2ft [609.6 mm] length

ASO Safety Solutions Industrial Shears

Part Number	Price	Description	Use With	Contents
9501-0160		Stainless steel industrial shears	Safety contact edges	1 shear

ASO Safety Solutions

25mm x 45mm SENTIR Edges and End Caps

Selection

Use the following Example Connections drawings to help you select the correct components for your system.

Example Connections - 45mm edges and end caps

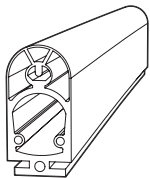

Example Connections for a 2-wire Safety Relay

Single Edge Connection

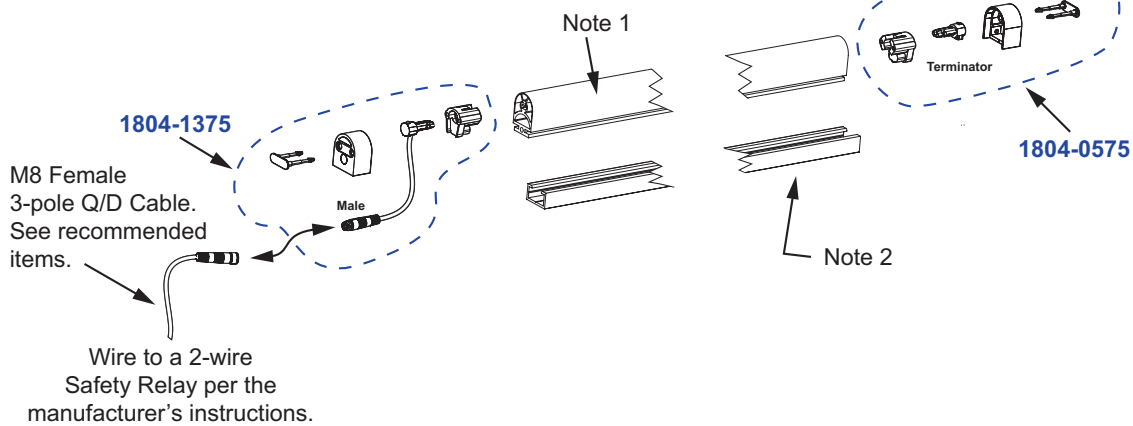

Multiple Edge Connection

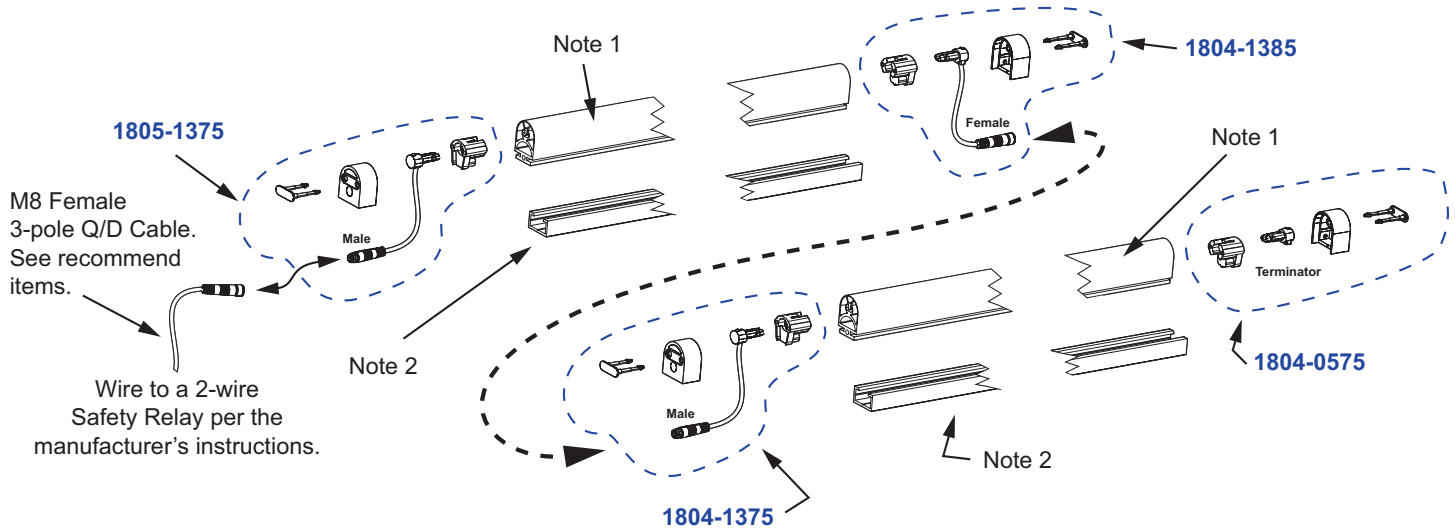

Note 1: **1502-2113** 2' Edge (mounting rail included)
1502-2114 5' Edge (mounting rail included)
1502-2115 20' (cut to length)
1502-2610 82' (cut to length)

Note 2: **2002-0231** 2' mounting rail
2002-0230 5' mounting rails (4 pack)

ASO Safety Solutions

25mm x 45mm SENTIR Edges and End Caps

Example Connections - 45mm edges and end caps

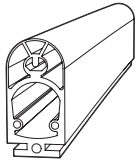

Example Connections for a 4-wire Safety Relay

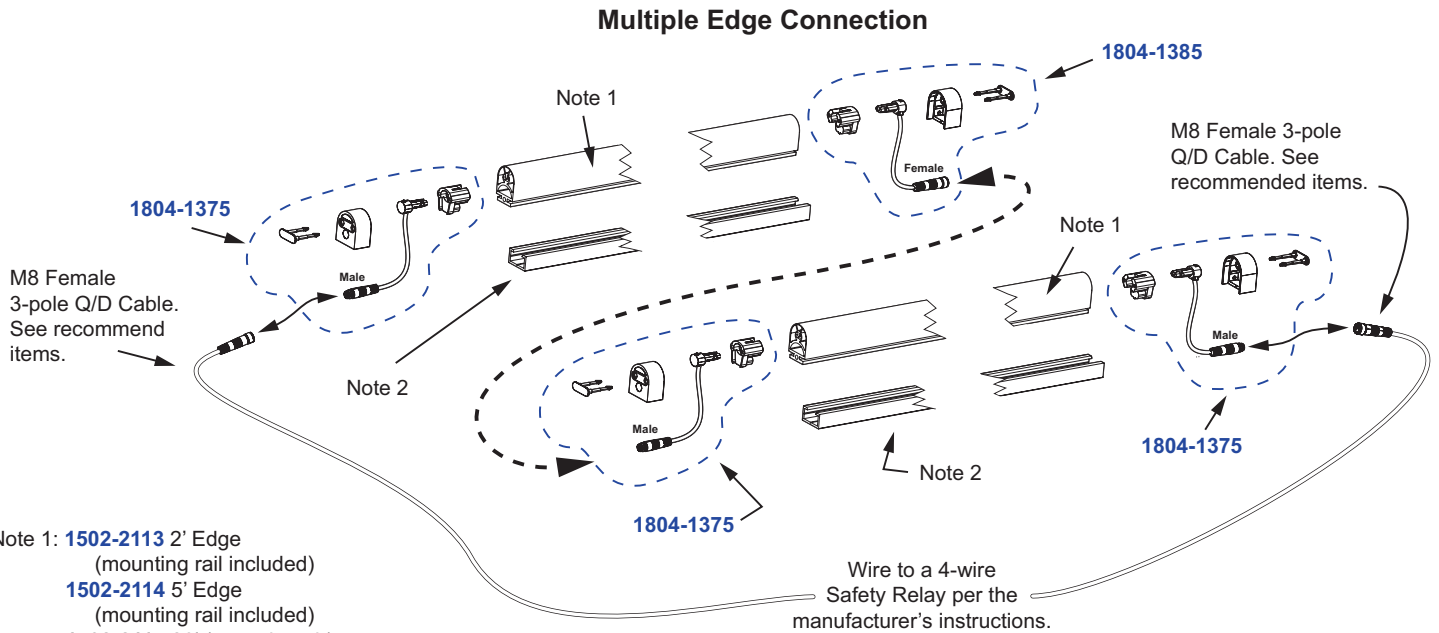
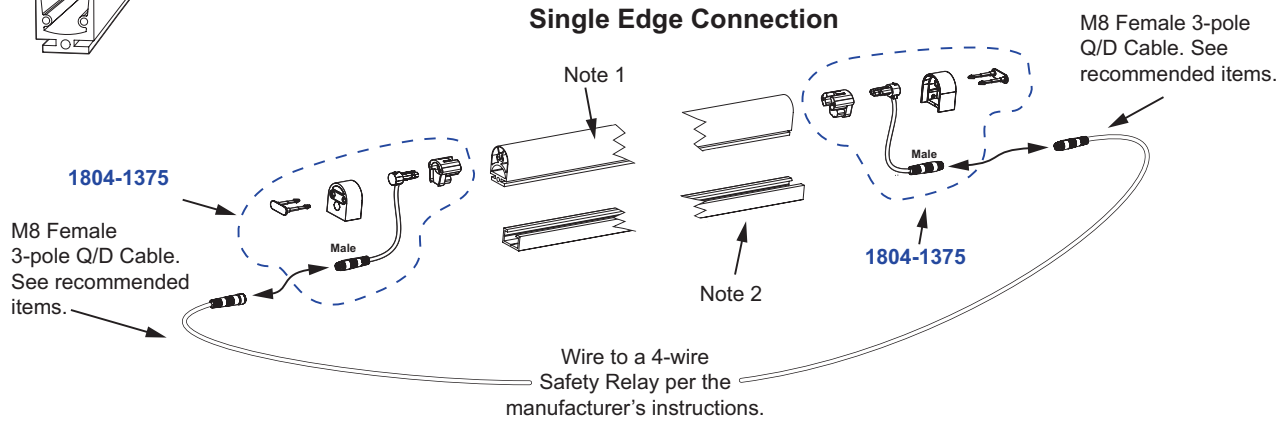

Note 1: **1502-2113** 2' Edge
(mounting rail included)
1502-2114 5' Edge
(mounting rail included)
1502-2115 20' (cut to length)
1502-2610 82' (cut to length)

Note 2: **2002-0231** 2' mounting rail
2002-0230 5' mounting rails (4 pack)

ASO Safety Solutions

25mm x 45mm SENTIR Edges and End Caps

SENTIR 25mm x 45mm Edges	
	General Specifications
Material	TPE
Material Hardness	68 Shore A
Weight (per meter)	440g ([5.5 oz] per meter)
Protection Class (Enclosure)	IP65
Switching Cycles	>30,000 [UL 325]
Switching Angle	2 x 45°
Actuation Resistance	≤ 500 Ohms
Actuation Force	63.1 N
Mechanical Life	10,000 cycles
Electrical Capacity	24VDC, 10mA
Max. Temperature Range	-25° to +75°C [-13° to +167°F]
Operating Temperature	-10° to +50°C [+14° to +122°F]
Max. Series Connection	5 contact edges or 100m [328.08 ft] based on the ASO safety relay 1114-0210
Inactive End Region with Higher Forces	30mm [1.18 in]
Connection Cables	LIY11Y 2 x 0.34 mm ²
Cable Material	PUR matte black
Agency Approvals	UL Recognized file E341185, CE

Dimensions

mm [in]

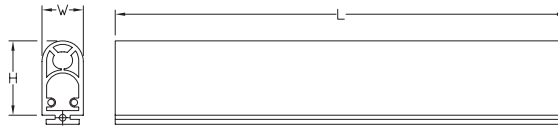

Safety Contact Edges - 45mm 1502-2XXX

PART INFORMATION			
PART NO.	W	H	LENGTH
1502-2113	25.0 [0.98]	45.0 [1.77]	609.6 mm [2] ft
1502-2114			1524.0 mm [5] ft
1502-2115			609.6 mm [20] ft
1502-2610			2499.6 mm [82] ft

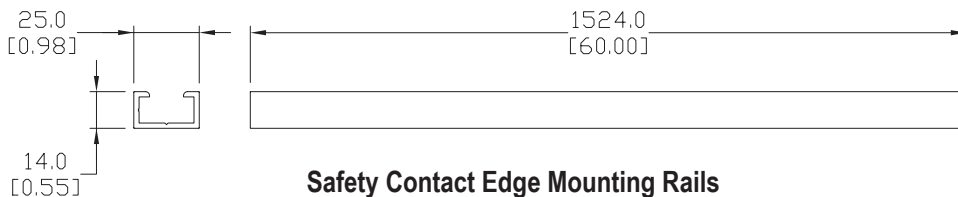

Safety Contact Edge Mounting Rails
2002-0230



Safety Contact Edge Mounting Rails
2002-0231

Safety Products



Warning: Safety products sold by AutomationDirect are Safety components only. The purchaser/installer is solely responsible for the application of these components and ensuring all necessary steps have been taken to assure each application and use meets all performance and applicable safety requirements and/or local, national and/or international safety codes as required by the application. AutomationDirect cannot certify that our products, used solely or in conjunction with other AutomationDirect or other vendors' products, will assure safety for any application. Any person using or applying any products sold by AutomationDirect is responsible for learning the safety requirements for their individual application and applying them, and therefore assumes all risks, and accepts full and complete responsibility, for the selection and suitability of the product for their respective application.

AutomationDirect does not provide design or consulting services, and cannot advise whether any specific application or use of our products would ensure compliance with the safety requirements for any application.