







# Pneumatic GVP Series Miniature Solenoid Valve Manifolds



NITRA manifolds designed to work with 10mm wide GVP series valves.

- Single to 6 stations
- #10-32 female threaded ports
- Precision machined
- Compact
- Anodized aluminum for corrosion resistance
- Made in USA



Nitra Pneumatic GVP Series 10mm Miniature Solenoid Valve Manifolds					
Item	Part No.	Description	A inches [mm]	Price	Weight (lbs)
	<b>GM-311</b>	NITRA pneumatic valve manifold, anodized aluminum, rectangular, (1) station, #10-32 female threaded inlet(s), #10-32 female threaded outlet(s), #10-32 female threaded exhaust(s). For use with GVP-21 and GVP-31 series solenoid valves.	N/A		0.05
	<b>GM-312</b>	NITRA pneumatic valve manifold, anodized aluminum, rectangular, (2) stations, #10-32 female threaded inlet(s), #10-32 female threaded outlet(s), #10-32 female threaded exhaust(s). For use with GVP-21 and GVP-31 series solenoid valves.	1.42 [36.1]		0.05
	<b>GM-314</b>	NITRA pneumatic valve manifold, anodized aluminum, rectangular, (4) stations, #10-32 female threaded inlet(s), #10-32 female threaded outlet(s), #10-32 female threaded exhaust(s). For use with GVP-21 and GVP-31 series solenoid valves.	2.25 [78.2]		0.10
	<b>GM-316</b>	NITRA pneumatic valve manifold, anodized aluminum, rectangular, (6) stations, #10-32 female threaded inlet(s), #10-32 female threaded outlet(s), #10-32 female threaded exhaust(s). For use with GVP-21 and GVP-31 series solenoid valves.	3.08 [78.2]		0.15

## Assembly Example

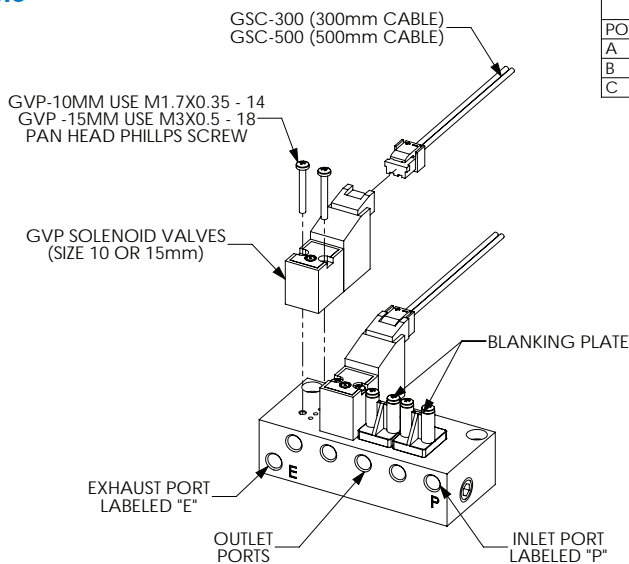

SINGLE STATION MANIFOLDS		
PORT	NC	NO
A	INPUT	EXHAUST
B	EXHAUST	INPUT
C	OUTPUT	OUTPUT

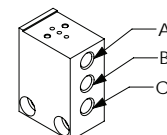

GM-311

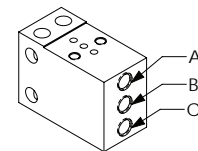

GM-312

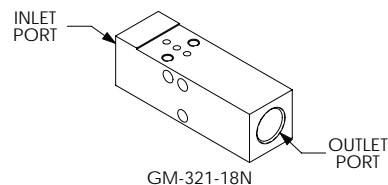

GM-321-18N



# Pneumatic GVP Series Miniature Solenoid Valve Manifolds

## Dimensions

mm [inches]

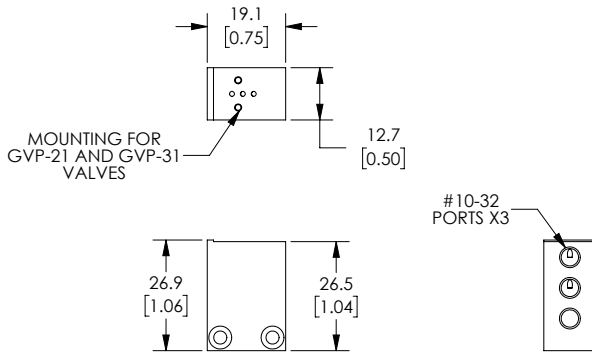

**Part No. GM-311**

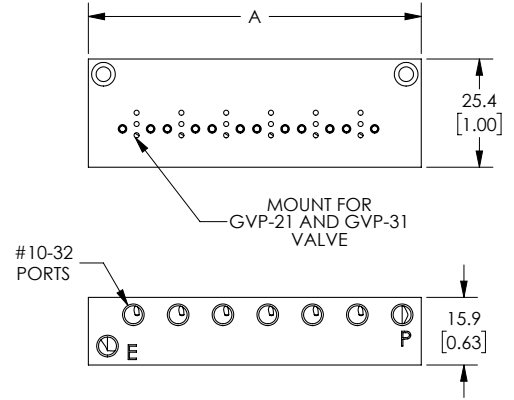

**Part No. GM-312, GM-314, GM-316**

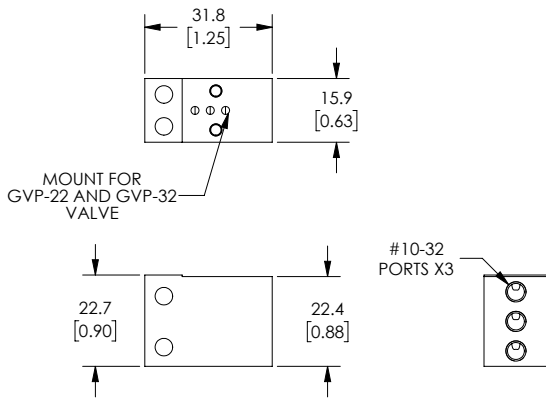

**Part No. GM-321**

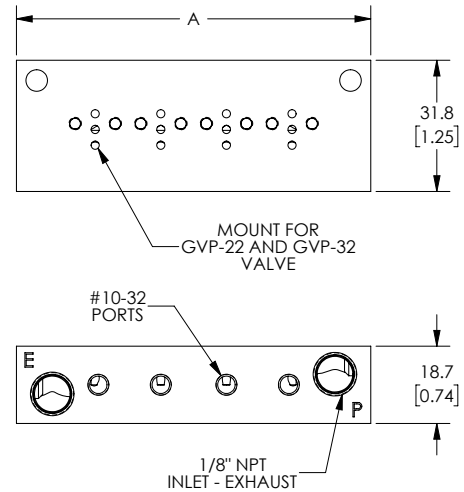

**Part No. GM-322, GM-324**

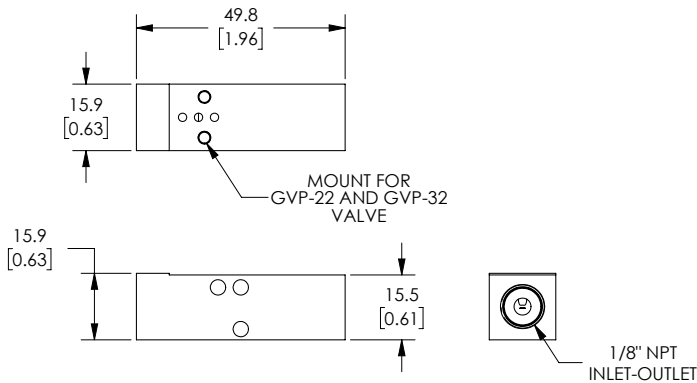





**Part No. GM-321-18N**

See our website for complete Engineering drawings.



# Pneumatic GVP Series Miniature Solenoid Manifold Accessories



Nitra Pneumatic GVP Series Miniature Solenoid Valve Manifold Accessories				
Item	Part No.	Description	Price	Weight (lbs)
	<b>GM-31BP</b>	NITRA blanking plate, nylon. For use with GM-31 series manifolds. Gasket and mounting screws included.		0.05
	<b>GM-32BP</b>	NITRA blanking plate, nylon. For use with GM-32 series manifolds. Gasket and mounting screws included.		0.05
	<b>GSC-300</b>	NITRA solenoid valve cable, miniature pin plug to pigtail, 11.8in/300mm cable length. For use with GVP series solenoid valves.		0.05
	<b>GSC-500</b>	NITRA solenoid valve cable, miniature pin plug to pigtail, 19.6in/500mm cable length. For use with GVP series solenoid valves.		0.05

## Dimensions

mm [inches]

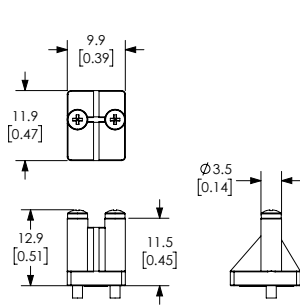

Part No. GM-31BP

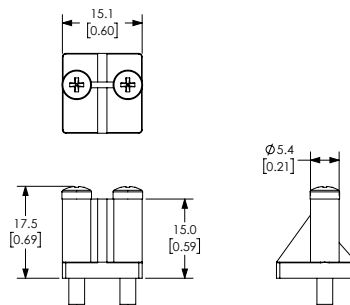

Part No. GM-32BP

See our website for complete Engineering drawings.