

Sensor Cables and Connectors

M12 Patch Cables with LED

- Right-angle M12 female plug with LED indication on one end and axial male plug on the other end
- PUR (polyurethane) jacket for oily and direct sunlight applications
- IP67 / IP68 / IP69K, II rated
- LED indication for 10–36 VDC PNP sensors only
- 0.3m, 0.6m, 1m, 2m, 5m, and 10m cable lengths

| Specifications | | | | | | |
|----------------|-------|-----------------|-------|--------------------------------|-----|--------|
| Part Number | Price | Length | Poles | Connectors | LED | Jacket |
| EVC322* | | 0.3 m [0.98 ft] | 4 | Right-angle female, axial male | Yes | PUR |
| EVC323* | | 0.6 m [1.97 ft] | 4 | Right-angle female, axial male | Yes | PUR |
| EVC324* | | 1m [3.28 ft] | 4 | Right-angle female, axial male | Yes | PUR |
| EVC325* | | 2m [6.5 ft] | 4 | Right-angle female, axial male | Yes | PUR |
| EVC326* | | 5m [16.4 ft] | 4 | Right-angle female, axial male | Yes | PUR |
| EVC327* | | 10m [32.8 ft] | 4 | Right-angle female, axial male | Yes | PUR |

*Note: LED for 10–36 VDC PNP devices only.

Do not use with NPN or analog output devices.

Do not use when white wire (Pin 2) is used for selection of a sensor function.

Do not use when emitter has check function.



Wiring

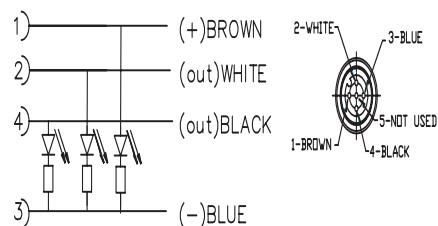

| Specifications | | | |
|--|--|---|--|
| Length | 2m [6.5 ft] / 5m [16.4 ft] / 10m [32.8 ft] | | |
| Nominal Voltage | 10–36 VDC | | |
| Max Current | 4A | | |
| LED Current Loading | <table border="0"> <tr> <td>10V input Brown wire LED: 1.7 mA White and/or Black LED: 0.9 mA</td> <td>36V input Brown wire LED: 7.3 mA White and/or Black LED: 4.7 mA</td> </tr> </table> | 10V input Brown wire LED: 1.7 mA White and/or Black LED: 0.9 mA | 36V input Brown wire LED: 7.3 mA White and/or Black LED: 4.7 mA |
| 10V input Brown wire LED: 1.7 mA White and/or Black LED: 0.9 mA | 36V input Brown wire LED: 7.3 mA White and/or Black LED: 4.7 mA | | |
| Protection Degree | IP67 / IP68 / IP69K | | |
| Material Nut | Nickel plated Brass | | |
| Jacket Material | Polyurethane (PUR) | | |
| Housing Material | Connector: Orange PUR, Socket: Black PUR | | |
| Contacts Material | Gold plated Brass | | |
| Tightening Torque | Plug: 0.6 to 1.5 N·m (take into account the maximum value of the counterpart) Socket: 0.6 to 1.5 N·m | | |
| Conductors Cross Section | 0.34 mm ² [22 AWG] | | |
| Ø Outer Cable | 5mm | | |
| Temperature Range | -25 to +90°C [-13 to 194°F] | | |
| Function Display Power LED | Green | | |
| Switching Status LED | 2 x Yellow | | |
| Drag Chain (Roller Cable Tray) Suitability | Bending Radius | min. 10 x cable diameter | |
| | Bending Cycles | >5 million | |
| | Travel Speed | Max. 3.3 m/s for a horizontal travel length of 5m and max. acceleration of 5 m/s ² | |
| | Torsional Strain | ±180°/m | |
| Agency Approvals | UL File E191684, RoHS | | |

Dimensions

mm [inches]

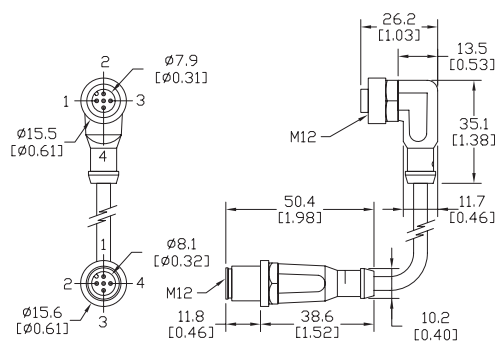

UL Reference

| | |
|---------------|------------------------------|
| EVC322 | VDOAH043MSS00.3H04STGH040MSS |
| EVC323 | VDOAH043MSS00.6H04STGH040MSS |
| EVC324 | VDOAH043MSS0001H04STGH040MSS |
| EVC325 | VDOAH043MSS0002H04STGH040MSS |
| EVC326 | VDOAH043MSS0005H04STGH040MSS |
| EVC327 | VDOAH043MSS0010H04STGH040MSS |

Note: Shown in UL file under Cable Assemblies using catalog number