



# General Purpose Nylon Cable Ties

## Overview

These general purpose Nylon 6.6 cable ties are slotted and held in place by the resistance of the elastic tooth against the rack. The tail of the strap is pulled through the head to form a noose that can only be tightened.

Used to fix and seal. The work load is calculated using a safety coefficient of no less than 2. A preload of no higher than 10% of the work load should be applied.

These cable ties are resistant to solvents and reagents, oil, gasoline, and hydrocarbons when used at low temperatures, in low concentrations, and for short periods of time.

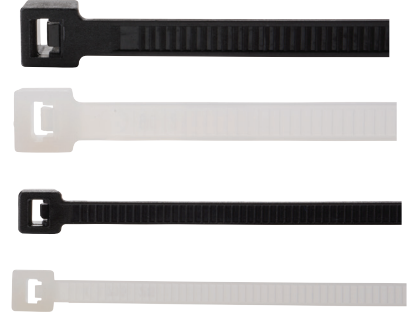

## Features

- UL 94: V2 self-extinguishing nylon
- Halogen-free
- Not resistant to mineral acids and oxidizing agents
- Designed for indoor applications
- Rounded edges to avoid cable damage
- Operating temperature:  
-40 to +85°C [-40 to +185°F]

## Agency Approvals

- UL Listed File E160935
- CE

General Purpose Nylon Cable Ties																
Part Number	Pcs/Bag	Price	Part Number	Pcs/Bag	Price	Color	Length		Width		Min. Bundle Ø		Max. Bundle Ø		Tensile Strength	
							mm	in	mm	in	mm	in	mm	in	Kg	lb
<a href="#">SEL.2.202</a>	100		<a href="#">SEL.2.302</a>	1000		Natural	100	3.94	2.5	0.10	2	0.08	24	0.94	11	24.25
<a href="#">SEL.3.202</a>	100		<a href="#">SEL.3.302</a>	1000		Black	100	3.94	2.5	0.10	2	0.08	24	0.94	11	24.25
<a href="#">SEL.2.204</a>	100		<a href="#">SEL.2.304</a>	1000		Natural	160	6.30	2.5	0.10	2	0.08	42	1.65	11	24.25
<a href="#">SEL.3.204</a>	100		<a href="#">SEL.3.304</a>	1000		Black	160	6.30	2.5	0.10	2	0.08	42	1.65	11	24.25
<a href="#">SEL.2.205</a>	100		<a href="#">SEL.2.305</a>	1000		Natural	200	7.87	2.5	0.10	2	0.08	55	2.17	11	24.25
<a href="#">SEL.3.205</a>	100		-	-	-	Black	200	7.87	2.5	0.10	2	0.08	55	2.17	11	24.25
<a href="#">SEL.2.210</a>	100		<a href="#">SEL.2.310</a>	1000		Natural	140	5.51	3.5	0.14	3	0.12	36	1.42	20	44.09
<a href="#">SEL.3.210</a>	100		<a href="#">SEL.3.310</a>	1000		Black	140	5.51	3.5	0.14	3	0.12	36	1.42	20	44.09
<a href="#">SEL.2.211</a>	100		<a href="#">SEL.2.311</a>	1000		Natural	200	7.87	3.5	0.14	3	0.12	55	2.17	20	44.09
<a href="#">SEL.3.211</a>	100		-	-	-	Black	200	7.87	3.5	0.14	3	0.12	55	2.17	20	44.09
<a href="#">SEL.2.212</a>	100		-	-	-	Natural	280	11.02	3.5	0.14	3	0.12	80	3.15	20	44.09
<a href="#">SEL.3.212</a>	100		-	-	-	Black	280	11.02	3.5	0.14	3	0.12	80	3.15	20	44.09
<a href="#">SEL.2.214</a>	100		-	-	-	Natural	360	14.17	3.5	0.14	5	0.20	103	4.06	20	44.09
<a href="#">SEL.3.214</a>	100		-	-	-	Black	360	14.17	3.5	0.14	5	0.20	103	4.06	20	44.09

Continued on next page



# General Purpose Nylon Cable Ties

Continued from previous page

General Purpose Nylon Cable Ties																
Part Number	Pcs/ Bag	Price	Part Number	Pcs/ Bag	Price	Color	Length		Width		Min. Bundle Ø		Max. Bundle Ø		Tensile Strength	
							mm	in	mm	in	mm	in	mm	in	Kg	lb
<a href="#">SEL.2.221</a>	100		<a href="#">SEL.2.321</a>	1000		Natural	160	6.30	4.5	0.18	3	0.12	38	1.50	28	61.73
<a href="#">SEL.3.221</a>	100		–	–	–	Black	160	6.30	4.5	0.18	3	0.12	38	1.50	28	61.73
<a href="#">SEL.2.222</a>	100		<a href="#">SEL.2.322</a>	1000		Natural	180	7.09	4.5	0.18	3	0.12	45	1.77	28	61.73
<a href="#">SEL.3.222</a>	100		–	–	–	Black	180	7.09	4.5	0.18	3	0.12	45	1.77	28	61.73
<a href="#">SEL.2.425</a>	100		–	–	–	Natural	280	11.02	4.5	0.18	5	0.20	76	2.99	28	61.73
<a href="#">SEL.3.425</a>	100		–	–	–	Black	280	11.02	4.5	0.18	5	0.20	76	2.99	28	61.73
<a href="#">SEL.2.426</a>	100		–	–	–	Natural	360	14.17	4.5	0.18	5	0.20	101	3.98	28	61.73
<a href="#">SEL.3.426</a>	100		–	–	–	Black	360	14.17	4.5	0.18	5	0.20	101	3.98	28	61.73
<a href="#">SEL.2.434</a>	100		–	–	–	Natural	360	14.17	7.5	0.30	5	0.20	101	3.98	65	143.30
<a href="#">SEL.3.434</a>	100		–	–	–	Black	360	14.17	7.5	0.30	5	0.20	101	3.98	65	143.30
<a href="#">SEL.2.143</a>	100		–	–	–	Natural	780	30.71	9	0.35	20	0.79	235	9.25	80	176.37
<a href="#">SEL.3.143</a>	100		–	–	–	Black	780	30.71	9	0.35	20	0.79	235	9.25	80	176.37
<a href="#">SEL.2.154</a>	100		–	–	–	Natural	920	36.22	9	0.35	40	1.57	280	11.02	80	176.37
<a href="#">SEL.3.154</a>	100		–	–	–	Black	920	36.22	9	0.35	40	1.57	280	11.02	80	176.37

## Cable Tie Assortment Kit

Bucket Mix – Designed for professionals and do-it-yourselfers in mind. Packaged in a practical reusable bucket shaped plastic container, these cable ties are available in convenient 1,200 or 800 pieces, in black and natural. The products are packaged in bags of 100 pieces. This enables the cable ties to preserve their physical characteristics until the time of use, ensuring optimal performance for every application.

Cable Tie Assortment Kit		
Part Number	Price	Description
<a href="#">BUCK.001</a>		SapiSelco cable tie assortment kit, black and natural. Package of 1200. Includes (300) 3.93in cable ties, (300) 7.09in cable ties, (300) 7.87in cable ties and (300) 9.84in cable ties.
<a href="#">BUCK.002</a>		SapiSelco cable tie assortment kit, black and natural. Package of 800. Includes (200) 3.93in cable ties, (200) 5.51in cable ties, (200) 7.09in cable ties and (200) 7.87in cable ties.



BUCK.001



BUCK.002

## Cable Tie Cutting Tool

The special angle of this cutter's tips enables clean cuts of the ties to sizes between 2.5 and 12.5 mm in width, maintaining the wired electric cables intact. The cutter can also be used for cutting cables.



PIN.009

## Collar Fastening Metal Plier

This tool makes it easier to tighten and cut collars. Use with Double-headed Cable Ties. Leaves a short length of tail close to the head. For use with up to 9mm wide cable ties.

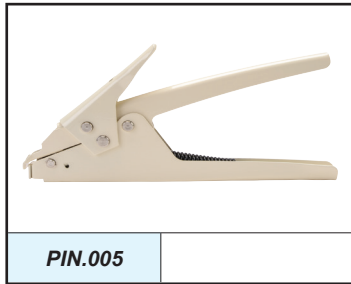

PIN.005

## Cable Tie Gun Installation Tool

For use with cable ties up to 5mm wide. This tool helps to adjust the preload and cut the tie. Tightening torque of 2.5 kg to 12kg.



PIN.003

## Bi-directional Nylon Square Bases



BAS.xMT.507



BAS.x.406

Note: Screw/mount not included

Bi-directional Nylon Square Bases						
Part Number	Pcs/Bag	Price	Color	Dual Adhesive	Dimensions	
					A	B
<a href="#">BAS.2MT.507</a>	100		natural	Yes	18.8 mm [0.74 in]	4.4 mm [0.17 in]
<a href="#">BAS.3MT.507</a>	100		black	Yes		
<a href="#">BAS.2MT.508</a>	100		natural	Yes	26.5 mm [1.04 in]	5.9 mm [0.23 in]
<a href="#">BAS.3MT.508</a>	100		black	Yes		
<a href="#">BAS.2.406</a>	100		natural	No		
<a href="#">BAS.3.406</a>	100		black	No		

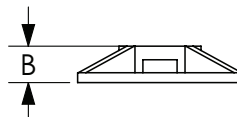
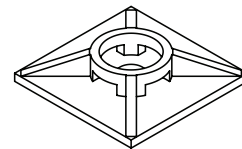
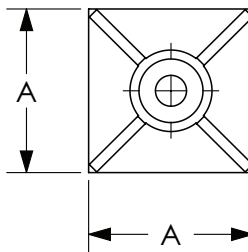



# Cable Ties Family Overview

## General Purpose Nylon Cable Ties



SapiSelco general purpose Nylon 6.6 cable ties are slotted and held in place by the resistance of the elastic tooth against the rack. These cable ties are resistant to solvents and reagents, oil, gasoline, and hydrocarbons when used at low temperatures, in low concentrations, and for short periods of time. Assortment Kit available.

## Colored Nylon Cable Ties



SapiSelco colored Nylon 6.6 cable ties are useful in applications that require distinct identifiers. These ties are colored with inorganic dyes and are resistant to solvents and reagents, oil, gasoline, and hydrocarbons when used at low temperatures, in low concentrations, and for short periods of time. Assortment Kit available.

## Stainless Steel Tooth Ties



SapiSelco stainless steel tooth ties are forged from nylon and hardened with added Molybdenum. This ensures extremely high mechanical strength and optimal resistance to corrosion. A single central raised section makes this tie particularly flexible, while guaranteeing maximum strength at the same time.

## UV Resistant Cable Ties



Exposure to sun and ultraviolet rays causes deterioration in nylon. SapiSelco specialty Nylon UV Resistant cable ties can resist and endure the harsh conditions of outdoor applications for up to 10 years. These ties can withstand temperatures up to 125°C [257°F].

## Metal Detector Readable Cable Ties

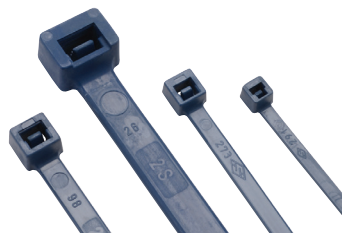

These ties are fabricated with a special composite of 6.6 polyamide and metal powder and are sensitive to electromagnetic fields. They are recommended in the food, pharmaceutical and chemical industry. They are useful in applications where, for safety reasons, it is necessary for a metal detector to be able to detect even very small fragments of these ties that may be mixed in with products.



These ties are low-cost, releasable, and reusable cable ties, suitable for lightweight loads.

The double-locking head enables securing two cable bundles with one tie. The body is completely rounded to eliminate all sharp edges guaranteeing reliable performance every time.

## Specialty Cable Ties



Nylon Releasable Tab



Screw Mount



Low Temp



Nylon Lashing Cable Tie



Identification Ties



Double-headed (Collars)

## Tools and Accessories



Cable Tie Cutting Tool



Collar Fastening Metal Plier



Cable Tie Gun Installation Tool



Bi-directional Nylon Square Bases