

# KS 50 Elements Quick Selection Guide

STEP 1 - Optical Elements Quick Selection Guide				
Type of Light	Part Number	Color	Operating Voltage	Price
Incandescent Permanent*	<a href="#">84610000</a>	Red	12-240V AC/DC	
	<a href="#">84620000</a>	Green		
	<a href="#">84630000</a>	Yellow		
	<a href="#">84640000</a>	Clear		
	<a href="#">84650000</a>	Blue		
Bulbs	<a href="#">95584035</a>	Clear	24VDC	
	<a href="#">95584038</a>	Clear	230VAC	
	<a href="#">95584057</a>	Clear	115VAC	
LED Permanent	<a href="#">84810055</a>	Red	24V AC/DC	
	<a href="#">84820055</a>	Green		
	<a href="#">84830055</a>	Yellow		
	<a href="#">84840055</a>	Clear		
	<a href="#">84850055</a>	Blue	115VAC	
	<a href="#">84810067</a>	Red		
	<a href="#">84820067</a>	Green		
	<a href="#">84830067</a>	Yellow		
	<a href="#">84840067</a>	Clear		
	<a href="#">84850067</a>	Blue		
LED Blinking Light	<a href="#">84811075</a>	Red	24V AC/DC	
	<a href="#">84821075</a>	Green		
	<a href="#">84831075</a>	Yellow		
	<a href="#">84841075</a>	Clear		
	<a href="#">84851075</a>	Blue	115VAC	
	<a href="#">84811067</a>	Red		
	<a href="#">84821067</a>	Green		
	<a href="#">84831067</a>	Yellow		
	<a href="#">84841067</a>	Clear		
	<a href="#">84851067</a>	Blue		
LED Flashing Light Element	<a href="#">84812055</a>	Red	24VDC	
	<a href="#">84822055</a>	Green		
	<a href="#">84832055</a>	Yellow		
	<a href="#">84842055</a>	Clear		
	<a href="#">84852055</a>	Blue		

\* Note: Bulbs are required for permanent incandescent optical element

STEP 2 - Audible Elements Quick Selection Guide					
Part Number	Description	Voltage	Tone Frequency	Maximum Volume	Price
<a href="#">84900075</a>	Buzzer element	24V AC/DC	2.1 kHz	80dB	
<a href="#">84900077</a>		115V AC/DC			

STEP 3 - Terminal Element Quick Selection			
Part Number	Description	Mounting	Price
<a href="#">84500000</a>	Screw terminal element for KS 50	surface, tube single-hole or bracket	

STEP 4 - Mounting Options/Accessories Quick Selection		
Part Number	Description	Price
<a href="#">97584510</a>	Anodized tube, 100mm [3.94 in] long	
<a href="#">97584025</a>	Anodized tube, 250mm [9.84 in] long	
<a href="#">97584040</a>	Anodized tube, 400mm [15.75 in] long	
<a href="#">97584060</a>	Anodized tube, 600mm [23.62 in] long	
<a href="#">97584080</a>	Anodized tube, 800mm [31.49 in] long	
<a href="#">97584003</a>	Anodized tube, 1000mm [39.37 in] long	
<a href="#">97584090</a>	Plastic base for 25mm [0.98 in] diameter tube	
<a href="#">97584091</a>	Metal base for 25mm [0.98 in] diameter tube	
<a href="#">96000030</a>	Foldaway base for 25mm [0.98 in] diameter tube	
<a href="#">97584501</a>	Base for surface mounting, includes rubber seal	
<a href="#">97584502</a>	Bracket for wall mounting	

STEP 5 - Contact Boxes & Brackets Quick Selection		
Part Number	Description	Price
<a href="#">97584001</a>	Contact box with side exit cable	
<a href="#">97584004</a>	Contact box with magnetic base and side exit cable	
<a href="#">96000014</a>	Bracket for base mounting with concealed cable entry	
<a href="#">96000001</a>	Bracket for base mounting	



KS 50 LED Light Element

# KS 50 Optical Elements Specifications

KS 50 Optical Elements Technical Specifications											
Part Number	Color	Drawing Link	Description	Operating Voltage	Current Consumption	Starting Current	Operating Temp/ Protection	Life Duration	Flash Frequency	Housing Material	Weight g [oz]
<a href="#">84610000</a>	Red	<a href="#">PDF</a>	Incandescent Permanent Light	12-240V AC/DC (bulb sold separately)	Depends on bulb selection. (bulb sold separately)	-	-20 to 50°C [-4 to 122°F] IP54	up to 5,000h	-	Polycarbonate	40 [1.41]
<a href="#">84620000</a>	Green	<a href="#">PDF</a>									
<a href="#">84630000</a>	Yellow	<a href="#">PDF</a>									
<a href="#">84640000</a>	Clear	<a href="#">PDF</a>									
<a href="#">84650000</a>	Blue	<a href="#">PDF</a>									
<a href="#">84810055</a>	Red	<a href="#">PDF</a>	LED Permanent Light Element	24V AC/DC	max. 45mA	max. 500mA	-20 to 50°C [-4 to 122°F] IP54	up to 100,000h	-	Polycarbonate	45 [1.59]
<a href="#">84820055</a>	Green	<a href="#">PDF</a>									
<a href="#">84830055</a>	Yellow	<a href="#">PDF</a>									
<a href="#">84840055</a>	Clear	<a href="#">PDF</a>									
<a href="#">84850055</a>	Blue	<a href="#">PDF</a>									
<a href="#">84810067</a>	Red	<a href="#">PDF</a>		115VAC	max. 25mA	-	-20 to 50°C [-4 to 122°F] IP54	up to 100,000h	-	Polycarbonate	45 [1.59]
<a href="#">84820067</a>	Green	<a href="#">PDF</a>									
<a href="#">84830067</a>	Yellow	<a href="#">PDF</a>									
<a href="#">84840067</a>	Clear	<a href="#">PDF</a>									
<a href="#">84850067</a>	Blue	<a href="#">PDF</a>									
<a href="#">84811075</a>	Red	<a href="#">PDF</a>	LED Blinking Light Element	24V AC/DC	max. 25mA	max. 500mA	-20 to 50°C [-4 to 122°F] IP54	up to 100,000h	1Hz on for 550ms	Polycarbonate	45 [1.59]
<a href="#">84821075</a>	Green	<a href="#">PDF</a>									
<a href="#">84831075</a>	Yellow	<a href="#">PDF</a>									
<a href="#">84841075</a>	Clear	<a href="#">PDF</a>									
<a href="#">84851075</a>	Blue	<a href="#">PDF</a>									
<a href="#">84811067</a>	Red	<a href="#">PDF</a>		115VAC	max. 25mA	-	-20 to 50°C [-4 to 122°F] IP54	up to 100,000h	1Hz on for 550ms	Polycarbonate	45 [1.59]
<a href="#">84821067</a>	Green	<a href="#">PDF</a>									
<a href="#">84831067</a>	Yellow	<a href="#">PDF</a>									
<a href="#">84841067</a>	Clear	<a href="#">PDF</a>									
<a href="#">84851067</a>	Blue	<a href="#">PDF</a>									
<a href="#">84812055</a>	Red	<a href="#">PDF</a>	LED Flashing Light Element	24VDC	45mA	max. 500mA	-20 to 50°C [-4 to 122°F] IP54	up to 50,000h	1Hz on for 10ms	Polycarbonate	56 [1.98]
<a href="#">84822055</a>	Green	<a href="#">PDF</a>			40mA						
<a href="#">84832055</a>	Yellow	<a href="#">PDF</a>			45mA						
<a href="#">84842055</a>	Clear	<a href="#">PDF</a>			40mA						
<a href="#">84852055</a>	Blue	<a href="#">PDF</a>			40mA						



KS 50 Incandescent Permanent Light Element



Bulbs for Incandescent Permanent Optical Element				
Part Number	Description	Wattage	Voltage	Life Duration
<a href="#">95584035</a>	Bulb for Incandescent Light BA15d Bayonet Socket	5W	24VDC	up to 5,000h
<a href="#">95584038</a>			230VAC	
<a href="#">95584057</a>			115VAC	

# Configuring Your KombiSIGN 50 Stack Light

## STEP 1

Select the required optical elements for your application



- Optical Signal Elements**
- Incandescent Permanent Light
  - LED Permanent Light
  - LED Blinking Light
  - LED Flashing Light

## STEP 2

Select the optional audible element for your application



- Audible Signal Elements**
- Buzzer Element

## STEP 3

Select the terminal element for your mounting option (includes cap)



Terminal element for surface, tube, single hole and bracket mounting

Order no.  
84500000

### Base/Bracket Mounting

### Tube Mounting

## STEP 4

Select the appropriate mounting option and accessories



Bracket for wall mounting

Order no.  
97584502



Base for surface mounting, includes rubber seal

Order no.  
97584501

Tube Ø 25mm, all anodized

Length	Order no.
100 mm long	97584510
250 mm long	97584025
400 mm long	97584040
600 mm long	97584060
800 mm long	97584080
1000 mm long	97584003

Base for Tube, plastic  
Order no. 97584090

Base for Tube, metal  
Order no. 97584091

Foldaway Base  
Order no. 96000030



## STEP 5

Where appropriate, select the bracket and the contact box



Contact box with side cable exit  
Order no. 97584001



Contact box with magnetic base and side cable exit  
Order no. 97584004



Bracket for base mounting with concealed cable entry  
Order no. 96000014



Bracket for base mounting  
Order no. 96000001

# Werma Modular Stack Lights Overview



# WERMA

S I G N A L T E C H N I K

## Description

WERMA's modular stack light system offers total choice and flexibility as it allows for a completely free combination of optical and audible signal elements. The bayonet mechanism allows elements to be mechanically and electrically connected within seconds.

This means that elements can be safely and easily changed (contact-voltage proof) without the need for tools.

Typical product applications include; machine tools, packaging machines, conveyor systems, printing machines, loading docks, retail centers (check outs), queuing indicators for theme parks, and more.

## Product highlights:

- Signal elements in common voltages (24V DC and 115V AC)
- Modular system allows combination as required
- Two different sizes (70 and 50 mm diameter)
- Five colors available
- Wide range of audible elements
- Diverse and flexible solutions

## Simple assembly with bayonet mechanism

- Simple mounting and removal of the elements
- New combinations at the twist of a hand
- Tool-free bulb change
- Position marks to guide alignment



# Werma Stack Lights Family Overview

## KombiSIGN 71

Modular IP65-rated stack light system with 70 mm diameter for use in standard applications.

KS 71 stack lights are available in 5 colors and multiple light effects (permanent, blinking, rotating, flashing). Multiple light sources (incandescent, LED, Xenon tube) and a wide variety of mountings are available. Combine up to 5 elements per terminal. Various terminal design choices are available as well as multiple voltages and audible elements up to 105 dB.

### KS 71 Terminal Elements



Screw terminals



CAGE CLAMP® terminals

## KombiSIGN 50

Modular IP54-rated stack light system with 50 mm diameter for use on smaller machines.

KS 50 stack lights are available in 5 colors with either permanent or blinking light effects in multiple voltages. A choice of incandescent or LED light sources is available as well as an 80 dB audible element. Elements can be combined in a variety of mountings, up to 4 elements per mounting for 360° of visibility.

### KS 50 Terminal Element



Screw terminal



## Safe and efficient connection thanks to CAGE CLAMP® technology

Terminal elements with CAGE CLAMP® technology enable leads to be quickly and easily wired, guaranteeing a secure and reliable contact.

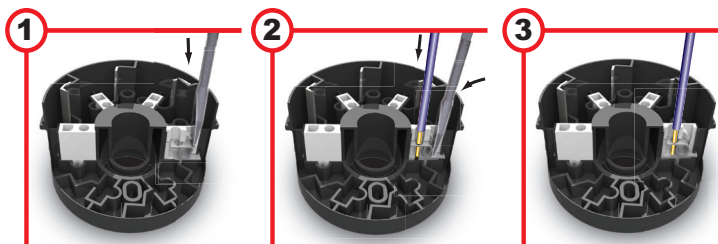

1. Insert screwdriver at a slight angle into opening as far as possible.

2. Open spring-loaded clamp with the help of the screwdriver and insert wire as far as possible.

3. Remove screwdriver - the wire is firmly clamped.

CAGE CLAMP® is a registered trademark of WAGO Kontakttechnik GmbH.